

### ★ Chimney Installation

#	Description	6"	8"
1	Chimney Cap	4909	4935
2	Chimney Pipe 24" Class A	4803	4812
3	Storm Collar	4917	4943
4	Roof Flashing 0/12 -6/12 Pitch	4915	4941
5	Chimney Pipe 36" Class A	4804	4813
6	Finishing Collar	4912	4938
7	Slip Connector 14"	4920	4946
8	Black Pipe 24" (4)	4918	4944
9	Black Tee with Cap	4923	4949
10	Barometric Damper	0005	0005
11	Roof Support Bracket (not shown)	4910	4936

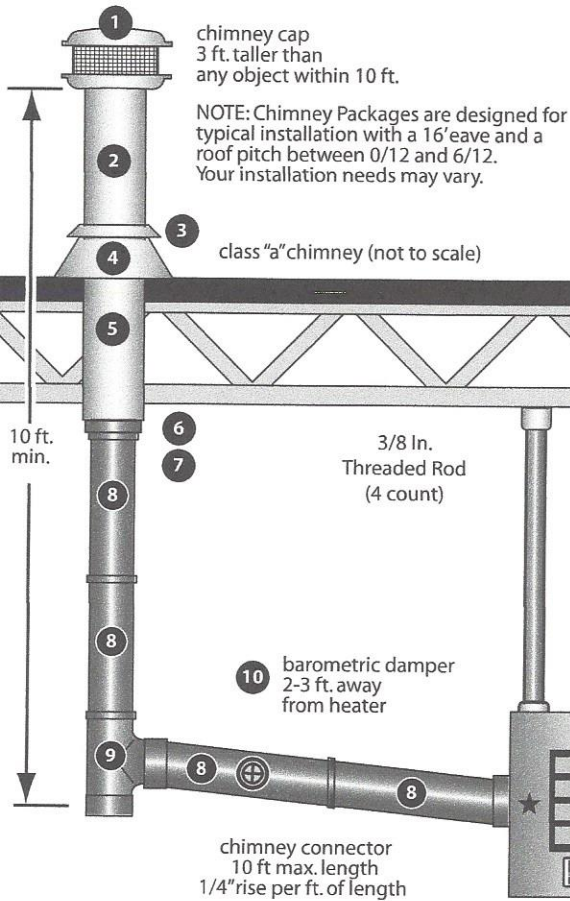

Lanair features quality: **SIMPSON** **Dura-Vent**

★ room thermostat

★ = supplied by lanair

Complete system includes: heater, pump, filters, fuel piping kit (all fuel lines and fittings), thermostat, secondary air regulator and 80 gallon tank.

tank specifications H35" x W22" x D35" For use with HI series heaters.

Install in accordance with owner's/operator's manual to state and local codes.

main power 120v-60hz-20amp



service disconnect



8 ft. min.

- ★ oil bypass regulator
- ★ pump assembly
- ★ primary strainer

- ★ 80 gallon tank
- ★ check valve and oil strainer

★ secondary air regulator

★ fuel line (20' copper)

primary air regulator

fill oil here

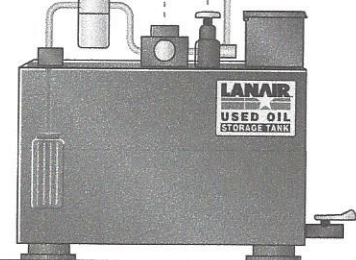

# LANAIR® waste oil-fired HEATERS

## MX-300 TECHNICAL SPECIFICATIONS



# MIX-300

Includes: heater, secondary air regulator, oil by-pass regulator, pump assembly, primary waste oil strainer, check valve, barometric damper, oil supply strainer and thermostat.

### FEATURES:

- UL Listed
- 300,000 BTU
- Fine grain galvanized (rust-resistant) cabinet
- MX Series High-Performance Burner
- Internal fan to reduce excess noise
- Adjustable, locking louvers
- Top exhaust

Heat Range (btuh)*	to 300,000
Fuel Input (gph)	2.14
Heating Area (sq. ft.)**	to 10,000
Power Supply (AC)	120V.60HZ
Cabinet Dimensions (H x W x D)	36" x 46" x 48"
Hanging Weight (lbs.)	630
Axial fan (cfm)	4,600
Chimney Pipe***	8" Class "A"
Compressed Air****	2 CFM - 15 PSI
Combustion Chamber	10 GA CRS
Chimney Location	Top Side
Warranty (Parts/Chamber)	1 year / 10 year

\* BTUH value varies with fuel type

\*\* The suggested heating area is based on buildings with minimal heat loss due to open doors, construction, materials, windows, insulation, etc...

\*\*\* Chimney package is optional

\*\*\*\* Customer supplied. Source must be capable of producing 2.0 CFM @ 60 PSI.

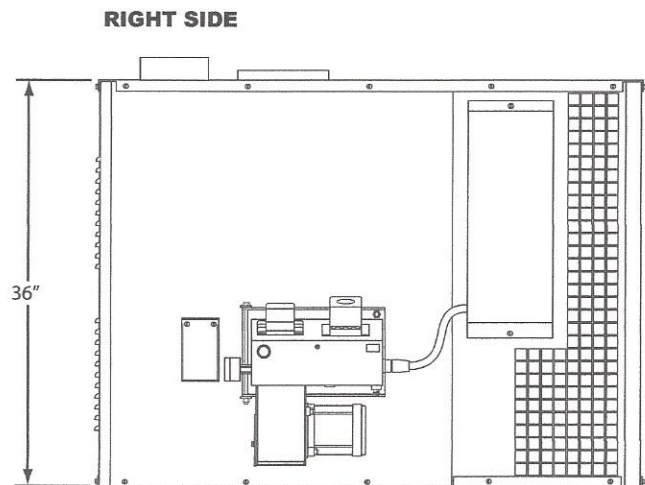
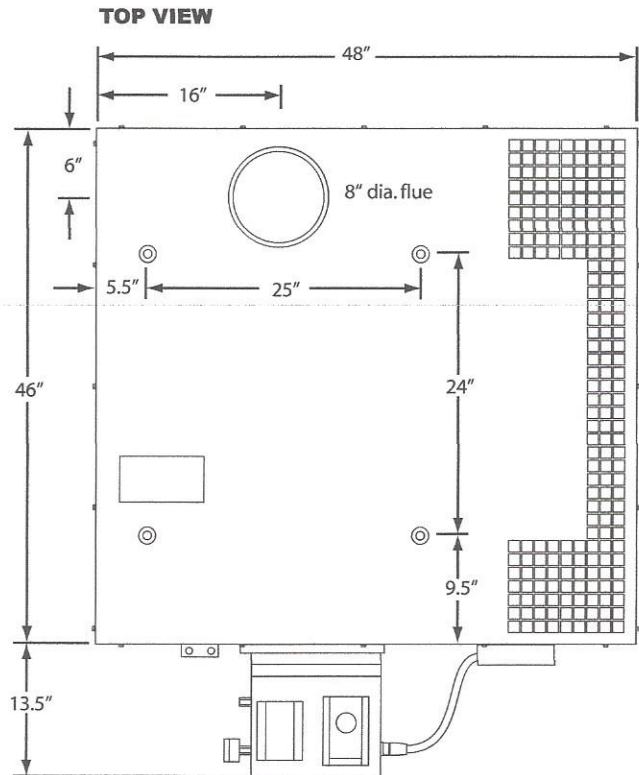

**\* NOT FOR RESIDENTIAL USE**