

★ Chimney Installation

| # | Description | 6" | 8" |
|----|----------------------------------|------|------|
| 1 | Chimney Cap | 4909 | 4935 |
| 2 | Chimney Pipe 24" Class A | 4803 | 4812 |
| 3 | Storm Collar | 4917 | 4943 |
| 4 | Roof Flashing 0/12 -6/12 Pitch | 4915 | 4941 |
| 5 | Chimney Pipe 36" Class A | 4804 | 4813 |
| 6 | Finishing Collar | 4912 | 4938 |
| 7 | Slip Connector 14" | 4920 | 4946 |
| 8 | Black Pipe 24" (4) | 4918 | 4944 |
| 9 | Black Tee with Cap | 4923 | 4949 |
| 10 | Barometric Damper | 0005 | 0005 |
| 11 | Roof Support Bracket (not shown) | 4910 | 4936 |

1 chimney cap
3 ft. taller than any object within 10 ft.

NOTE: Chimney Packages are designed for typical installation with a 16' eave and a roof pitch between 0/12 and 6/12. Your installation needs may vary.

3 class "a" chimney (not to scale)

10 ft. min.

3/8 In. Threaded Rod (4 count)

ceiling hung

Lanair features quality:



10 barometric damper 2-3 ft. away from heater

chimney connector 10 ft max. length 1/4" rise per ft. of length

★ room thermostat



★ = supplied by lanair

Complete system includes: heater, pump, filters, fuel piping kit (all fuel lines and fittings), thermostat, secondary air regulator and 80 gallon tank.

tank specifications H35" x W22" x D35"
For use with HI series heaters.

Install in accordance with owner's/operator's manual to state and local codes.

main power 120v-60hz-20amp



service disconnect



8 ft. min.

★ secondary air regulator

★ fuel line (20' copper)

primary air regulator

★ oil bypass regulator

★ pump assembly

★ primary strainer

fill oil here

★ 80 gallon tank

★ check valve and oil strainer

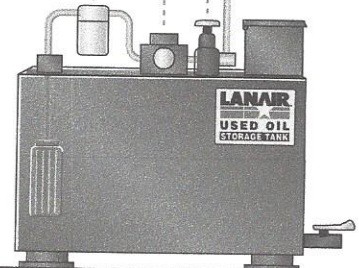

*** NOT FOR RESIDENTIAL USE**

Specifications and designs subject to change without notice

LANAIR® waste oil-fired HEATERS

MX-250 TECHNICAL SPECIFICATIONS



MIX-250

Includes: heater, secondary air regulator, oil by-pass regulator, pump assembly, primary waste oil strainer, check valve, barometric damper, oil supply strainer and thermostat.

FEATURES:

- UL Listed
- 250,000 BTU
- Fine grain galvanized (rust-resistant) cabinet
- MX Series High-Performance Burner
- Internal fan to reduce excess noise
- Adjustable, locking louvers
- Top exhaust

| | |
|--------------------------------|------------------|
| Heat Range (btuh)* | to 250,000 |
| Fuel Input (gph) | 1.79 |
| Heating Area (sq. ft.)** | to 8,500 |
| Power Supply (AC) | 120V. 60HZ |
| Cabinet Dimensions (H x W x D) | 36" x 46" x 48" |
| Hanging Weight (lbs.) | 630 |
| Axial fan (cfm) | 4,600 |
| Chimney Pipe*** | 8" Class "A" |
| Compressed Air**** | 2 CFM - 15 PSI |
| Combustion Chamber | 10 GA CRS |
| Chimney Location | Top Side |
| Warranty (Parts/Chamber) | 1 year / 10 year |

* BTUH value varies with fuel type

** The suggested heating area is based on buildings with minimal heat loss due to open doors, construction, materials, windows, insulation, etc...

*** Chimney package is optional

**** Customer supplied. Source must be capable of producing 2.0 CFM @ 60 PSI.

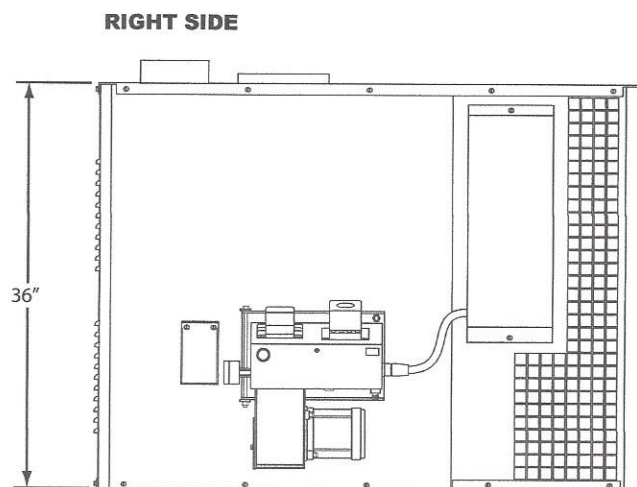
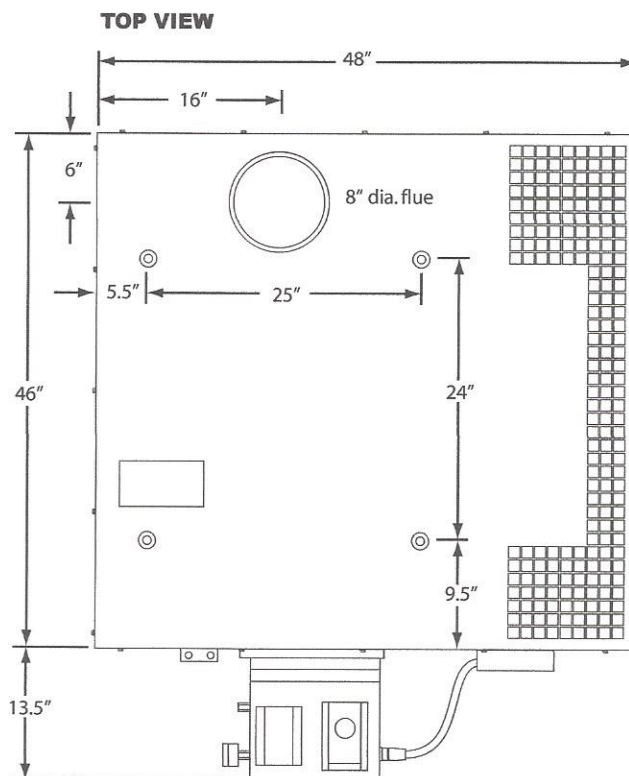

*** NOT FOR RESIDENTIAL USE**